

3.00 mm. SINGLE ROW TOP ENTRY HEADER



5768 SERIES. 3.00 mm. (0.118") pitch.

General Features

- Available in 2 through 12 circuits
- Mates with 3.00 mm. crimp housing 5750 series
- Tin plated 0.64 mm. square pin
- Fully shrouded with polarized slot. Positive lock
- With metallic board lock

Materials

- Insulator: Nylon 6T UL 94 V-0
- Contact: Tin plated brass
- Operating temperature: -40°C to +105°C
- RoHS compliant

Dimensional Information

Electrical Features

- Voltage rating: < 250V
- Current rating: < 5 A
- Contact resistance: < 10 mΩ
- Dielectric withstanding voltage: 500 V AC/minute
- Insulation resistance: >1000 MΩ

Mechanical Features

- Pin retention force to insulator: > 1,50 Kgf
- Durability: 25 cycles

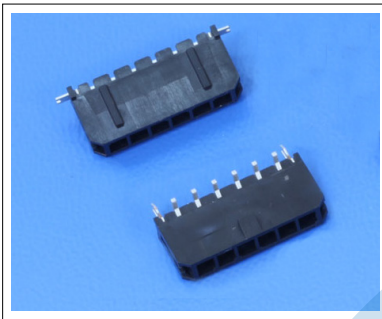

Circuits	Part Number		Dimensions			
	W/O Board Lock	With Board Lock	A	B	C	D
2	5768 – 2021E*	5768 – 2022E*	3.00 (.118)	9.65 (.380)	14.20 (.559)	7.30 (.287)
3	5768 – 2031E*	5768 – 2032E*	6.00 (.236)	12.65 (.498)	17.20 (.677)	10.30 (.406)
4	5768 – 2041E*	5768 – 2042E*	9.00 (.354)	15.65 (.616)	20.20 (.795)	13.30 (.524)
5	5768 – 2051E*	5768 – 2052E*	12.00 (.472)	18.65 (.734)	23.20 (.913)	16.30 (.642)
6	5768 – 2061E*	5768 – 2062E*	15.00 (.591)	21.65 (.852)	26.20 (1.031)	19.30 (.760)
7	5768 – 2071E*	5768 – 2072E*	18.00 (.709)	24.65 (.970)	29.20 (1.150)	22.30 (.878)
8	5768 – 2081E*	5768 – 2082E*	21.00 (.827)	27.65 (1.088)	32.20 (1.268)	25.30 (.996)
9	5768 – 2091E*	5768 – 2092E*	24.00 (.945)	30.65 (1.206)	35.20 (1.386)	28.30 (1.114)
10	5768 – 2101E*	5768 – 2102E*	27.00 (1.063)	33.65 (1.325)	38.20 (1.504)	31.30 (1.232)
11	5768 – 2111E*	5768 – 2112E*	30.00 (1.181)	36.65 (1.442)	41.20 (1.622)	34.30 (1.350)
12	5768 – 2121E*	5768 – 2122E*	33.00 (1.299)	39.65 (1.561)	44.20 (1.740)	37.30 (1.469)

Without Board Lock

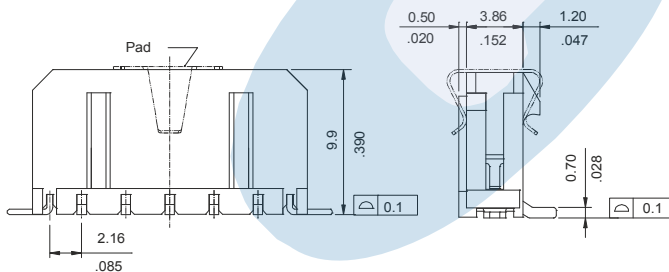

(E*) Packing Options

- E = 5. Tube + Metallic Pad
- E = 6. Reel + Metallic Pad

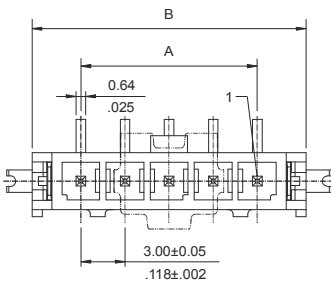

RECOMMENDED HOLE PATTERN

